

# SCEL-8000

Exit Sign & Emergency Lighting

## PRODUCT FEATURE

- Surface wall and surface ceiling mount
- High temperature long life Ni-MH battery
- Acrylic panel changeable
- Suitable for damp location
- 30 degree beam angle
- Full angle adjustable lamp head
- Extrusion aluminum alloy trim plate
- Self-testing / Self-diagnostic function available
- Slim type design
- 8" height letter
- Slim type design
- Remote capability design with additional battery



## TECHNICAL SPECIFICATION

Rated Power Supply	:	120/277 VAC 60Hz or 120/347 VAC 60Hz
Charge Time	:	24 hours
Discharge duration	:	1.5 hours
Test facility	:	Manual test
Mounting	:	Surface wall and surface ceiling
LED	:	High power LED for lamp head, SMD LED for exit sign
Luminance of safety sign	:	Meet UL 924
Ambient temperature	:	10°C - 40°C, suitable damp location
Insulation Class	:	Class I
Certification	:	UL 924

## RELATED PRODUCTS

- ◊ [EXL-1960 Emergency Lighting](#)
- ◊ [REM8000 Emergency Light](#)
- ◊ [RCEL800 Edge-li Combo](#)
- ◊ [S3 Series - Exit Sign](#)

## WARRANTY

- See [Limited Warranty Policy](#) for more additional information

## PRODUCT DIMENSION

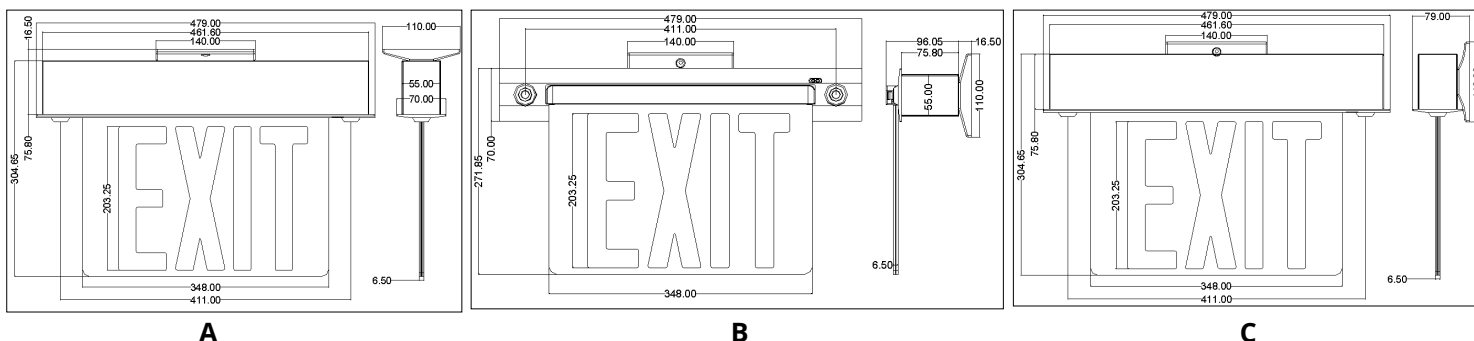

## ORDER INFORMATION: EXAMPLE: SCEL-8000-S-WH-CT-HO-RC

SCEL-8000	-		-		-		-		-	
MODEL	VOLTAGE		TRIM PLATE FINISHED		SELF-DIAGNOSTICS		BATTERY CAPACITY		REMOTE CAPABILITY	
SCEL-8000	S	Single face	AL	Aluminum	CT	Self-diagnostic	Blank	3.6V 1800mAh 250Lm output	RC	3.6V max. 3W remote capability
	D	Double face	WH	White	ZD	LynxEM® Wireless testing/ Reporting System	HO	3.6V 2500mAh 400Lm output		
			BK	Black						

# SCEL-80000

Exit Sign & Emergency Lighting

Project Name:	
Type:	

## LUMINOUS INTENSITY DISTRIBUTION

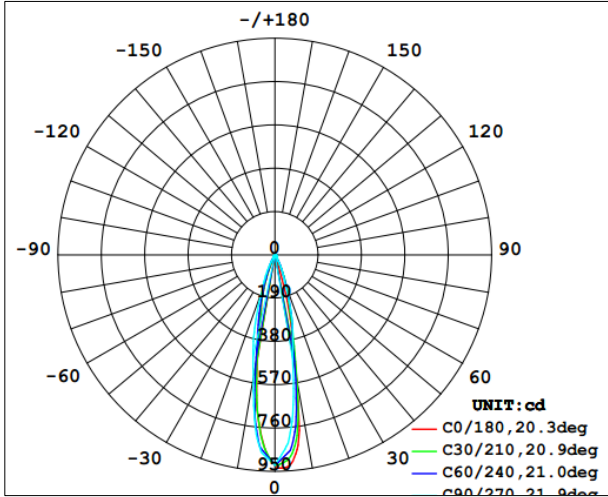

## CENTER TO CENTER SPACING

NFPA 101 requires 1.0 foot-candle average and 0.1 foot-candle minimum with a 40:1 maximum/minimum ratio. The corridor used is 100 feet long, 9 feet ceiling with a 6 feet wide walkway and 3 feet path of egress. The reflectance are 80% ceiling, 50% walls and 20% floor. The fixture mounting height is 7.5 feet.

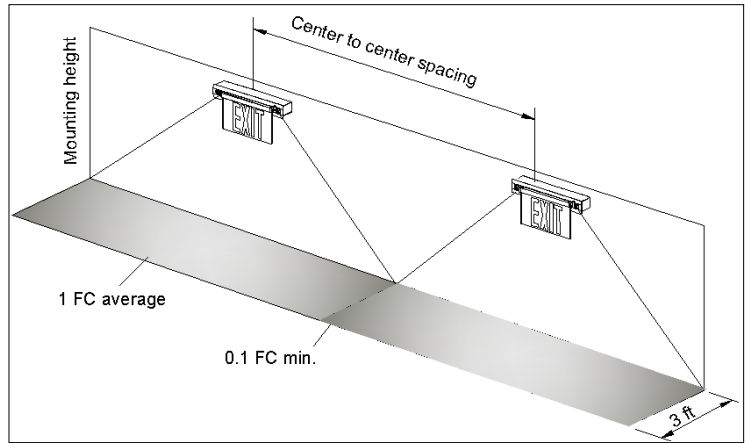

No.	MODEL	SPACING @ 7.5 FEET MOUNTING HEIGHT	SPACING @ 10 FEET MOUNTING HEIGHT
1	SCEL-8000-X	24 feet	25 feet
2	SCEL-8000-X-HO	30 feet	30 feet

## PRODUCT ASSEMBLY EXPLODED

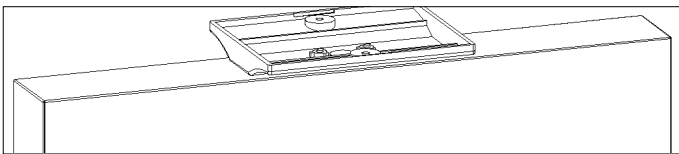

**Step1:** Install canopy to junction box.

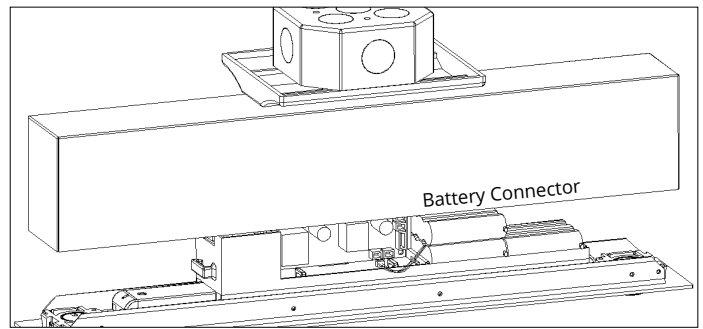

**Step 3:** Separate trim module and connect battery connector to PCBA

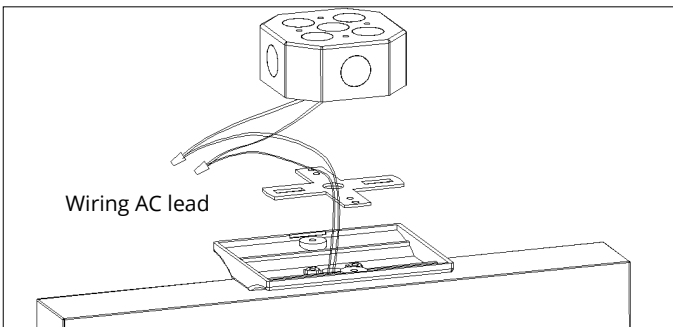

**Step2:** Wiring AC lead to outlet box, fixed the unit to outlet box

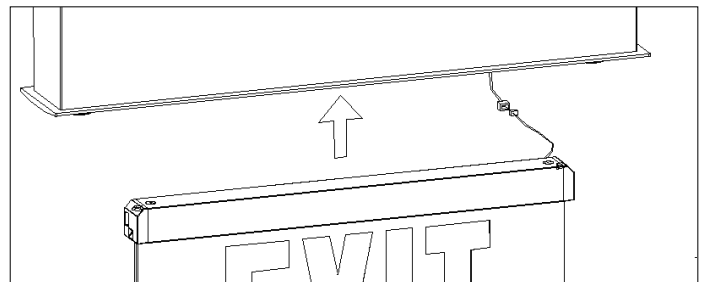

**Step 4:** Push the unit back to the junction box, assembly panel module

# SCEL-8000

Exit Sign & Emergency Lighting

Project Name:	
Type:	

## SURFACE CEILING OR SURFACE WALL MOUNT

**SURFACE CEILING MOUNT**

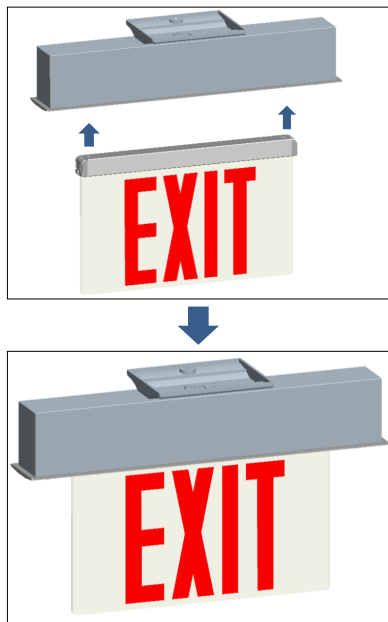

**SURFACE WALL MOUNT I**

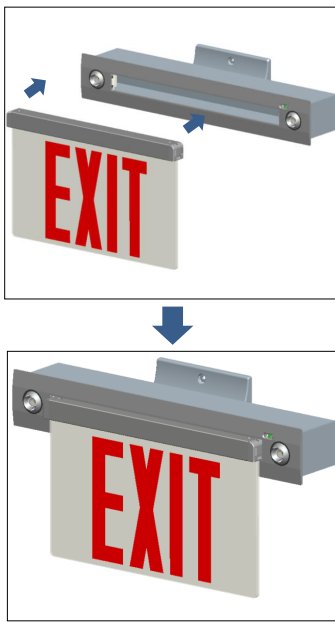

**SURFACE WALL MOUNT II**

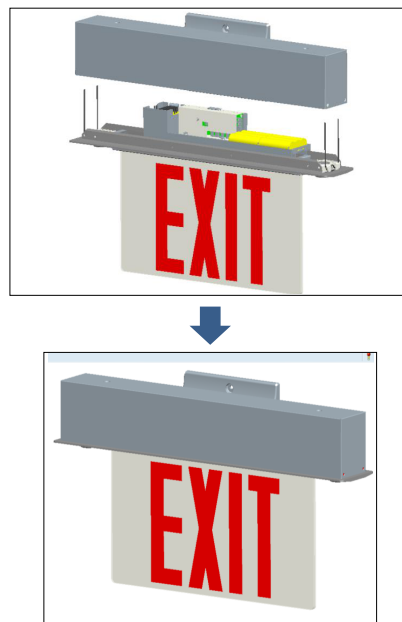

## PACKAGING

INNER BOX	:	515x260x110mm
CARTON BOX	:	530x445x240mm
Q'TY	:	4 PCS
N.W	:	10.3 KGS
G.W	:	12.4 KGS
MEA'S	:	2.42 CUFT

